

Impact Driver

Comes with intelligent features!



EY7202GQW Cordless Impact Driver Kit

12V

- High capacity 3.5Ah Ni-MH battery
- Compact size (LxHxW): 6-9/16" x 9-1/4" x 2-9/32"
- Light weight (incl. battery): 4.1 lbs.
- High power: Max. 1,100 in.lbs.
- Variable speed control/reversible
- Digital clutch with auto shut off.
- 3 Speed (High/Medium/Low)
- Charging Time (using EY0110B charger)*: 55 minutes
- Electric brake
- Ergonomic design
- LED work light
- Belt hook
- With an extra battery pack as standard equipment



Typical Application

- Air conditioning installation
- Automotive repair and maintenance
- Assemble and disassemble scaffolding
- Long wood screw/lag screw fastening

	High/Hard Mode	Medium Mode	Low/Soft Mode
Max. Torque	1,100 in.lbs ^{*1}	970 in.lbs ^{*2}	530 in.lbs ^{*3}
Speed at No Load	0-2,600 rpm	0-2,450 rpm	0-2,000 rpm
Impact/min.	0-2,800 ipm	0-2,500 ipm	0-2,000 ipm

^{*1} M14 High tensile bolt tightening for 3 sec. ^{*2} M10 High tensile bolt tightening for 3 sec. ^{*3} M8 High tensile bolt tightening for 3 sec.

The flush tightening impact driver makes work quick and gives a nice finish.

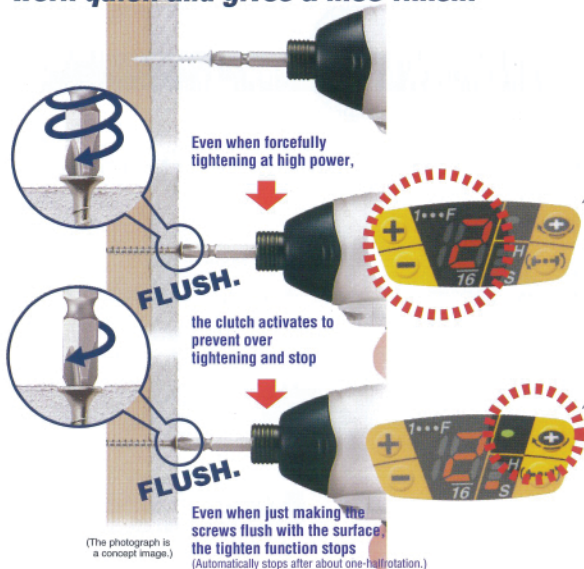

Digital clutch

Automatically stops before over tightening even when the switch is still being pulled.

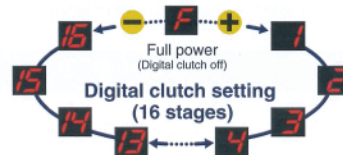

Tighten Function

Automatically stops after about one-half rotation each time the switch is pulled.

The tighten function is a new function that automatically stops after the screw has been tightened about one-half rotation. This makes fine flush alignment easy to do.

The screw rotation amount can be set.

Set the digital clutch stage



and press the Tighten button to turn on the tighten function. (Press the button again to turn it off.)

